

**TECHNICAL DATA**

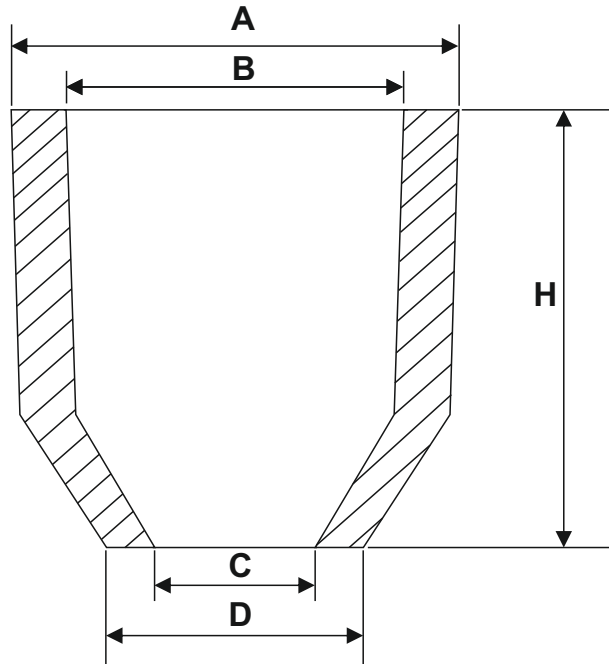

<b>POWEREX 90 ND ( EXOTHERMIC NECK DOWN SLEEVES )</b>								
SIZE	Modulus(mm)		Volume of Liquid Metal(CC)	Dimensions ( mm )				
	Effec.	Geo.		A	B	C	D	H
ND 1.5	11.19	6.91	81	58	38	20	40	60
ND 2	13.34	8.24	89	74	50	25	53	60
ND 2.5	17.95	11.15	223	87.5	63	30	56	85
ND 3	20.15	12.5	305	101	75	30	70	87
ND 4	26.33	16.67	705	130	100	40	88	115
ND 5	31.82	20.53	1300	158	126	50	92	136
ND 6	37.97	24.66	2240	186	150	60	108	161

Only minor variation to the extent of 0.5mm in diameter and 1 mm in height may occur.  
Dimensions given above are nominal. Sleeves are precise on dimensions.

